

WIDE RANGE OF PRODUCTS

MST-300VD/VDR



MST-600VD



MST-800VD



MST-1500VD



MST-2200VD



MST-3000VD



MST-300VD, MST-300VDR

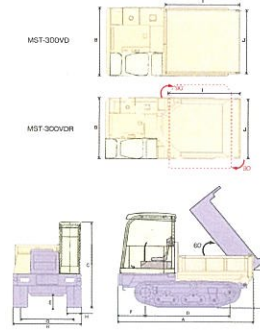

MST-600VD, MST-800VD

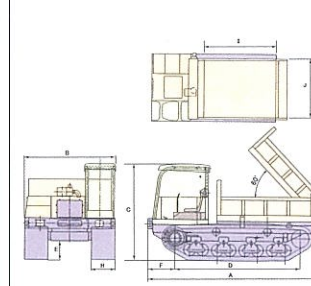

MST-1500VD, MST-2200VD, MST-3000VD

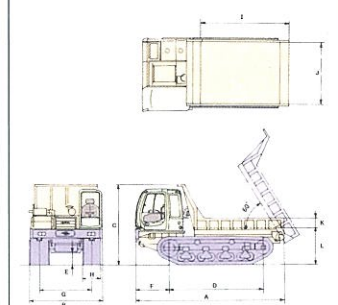

MODEL		①MST-300VD ②MST-300VDR	MST-600VD	MST-800VD	MST-1500VD	MST-2200VD	MST-3000VD
PERFORMANCE							
Max. Payload	kg (lbs)	2,500 (5,511 lbs)	3,300 (7,275 lbs)	4,800 (9,480 lbs)	7,000 (13,890 lbs)	10,000 (22,050 lbs)	15,000 (33,060 lbs)
Loading Capacity	m ³	① 0.88	1.28	1.77	2.34	3.53	4.9
		② 0.88					
Speed1 Low	km/h (mp/h)	6.0 (3.7mp/h)	6.6 (4.1mp/h)	8.0 (4.9mp/h)	7.6 (4.7mp/h)	8.0 (5.0mp/h)	8.0 (5.0mp/h)
Speed2 High	km/h (mp/h)	9.0 (5.6mp/h)	8.0 (4.9mp/h)	11.0 (6.8mp/h)	11.0 (6.8mp/h)	11.0 (6.8mp/h)	11.0 (6.8mp/h)
Ground Pressure(Empty)	kg/cm ²	① 0.16	0.16	0.17	0.17	0.23	0.25
		② 0.18					
MACHINE DIMENSION							
Machine Weight	kg (lbs)	① 2,200 (4,850 lbs) ② 2,400 (5,291 lbs)	4,000 (8,818 lbs)	6,500 (14,330 lbs)	9,200 (20,280 lbs)	13,500 (29,760 lbs)	17,500 (38,580 lbs)
Overall Length	A mm (f)	① 3,150 (10.3 f) ② 3,500 (11.4 f)	3,790 (12.4 f)	4,430 (14.5 f)	5,430 (17.8 f)	6,050 (19.9 f)	6,200 (20 f)
Overall Width	B mm (f)	1,740 (5.7 f)	2,040 (6.7 f)	2,435 (8.0 f)	2,750 (9.0 f)	2,905 (9.5 f)	3,000 (9.8 f)
Overall Height	C mm (f)	2,318 (7.6 f)	2,270 (7.4 f)	2,590 (8.5 f)	2,900 (9.5 f)	3,140 (10 f)	3,150 (10.3 f)
Wheelbase	D mm (f)	1,955 (6.4 f)	2,440 (8.0 f)	3,130 (10.2 f)	3,870 (12.7 f)	3,840 (12.6 f)	3,840 (12.6 f)
Min. Ground Clearance	E mm (f)	275 (0.9 f)	350 (1.1 f)	470 (1.5 f)	460 (1.5 f)	430 (1.4 f)	480 (1.6 f)
Front Overhang	F mm (f)	630 (2.0 f)	640 (2.1 f)	690 (2.3 f)	700 (2.3 f)	1,250 (4.1 f)	1,350 (4.4 f)
Crawler Distance	G mm (f)	1,250 (4.1 f)	1,450 (4.7 f)	1,700 (5.6 f)	1,800 (5.9 f)	2,050 (6.7 f)	2,200 (7.2 f)
Crawler Width	H mm (f)	350	500	600	700	750	800
Crawler Size	mm (f)	350x100x53	500x100x65	600x100x80	700x100x98	750x150x66	800x150x66
DUMP BODY							
Overall Length	I mm (f)	① 1,700 (5.5 f) ② 2,000 (6.5 f)	2,150 (7.0 f)	2,600 (8.5 f)	3,100 (10 f)	3,600 (11.8 f)	3,700 (12 f)
Overall Width	J mm (f)	① 1,400 (4.5 f) ② 1,450 (4.7 f)	1,700 (5.6 f)	1,950 (6.3 f)	2,200 (7.2 f)	2,450 (8.0 f)	2,500 (8.2 f)
Overall Height	K mm (f)	① 370 (1.2 f) ② 310 (1.0 f)	350 (1.1 f)	350 (1.1 f)	350 (1.1 f)	400 (1.3 f)	530 (1.7 f)
Ground Clearance	L mm (f)	825 (2.7 f)	1,010 (3.3 f)	1,160 (3.8 f)	1,350 (4.4 f)	1,450 (4.8 f)	1,490 (4.9 f)
ENGINE							
Model		KUBOTA V2203B	KUBOTA V3307	CAT C4.4	CAT C6.6	CAT C7	CAT C9
Nominal Output/rpm	HP/rpm	46/2,800	72/2,200	129/2,200	225/2,200	249/2,200	325/2,200
Nominal Output/rpm	kw/rpm	34/2,800	54/2,200	96.5/2,200	168/2,200	186/2,200	242/2,200
OTHERS							
		—	—	Mitsubishi 4D34 (OPTION)	Mitsubishi 6D16 (OPTION)	—	—
		① CANOPY ② CANOPY	CANOPY	CABIN CANOPY(OPTION)	CABIN CANOPY(OPTION)	CABIN	CABIN
	Swivel dump body	—	—	Heater	Air Conditioner	Air Conditioner	Air Conditioner

Specifications are subject to change without notice.